



WF12LCDA

WIFI SMART CLOCK

User Manual

WF12LCDA WiFi Clock



CONTROL BUTTONS ON THE BACK

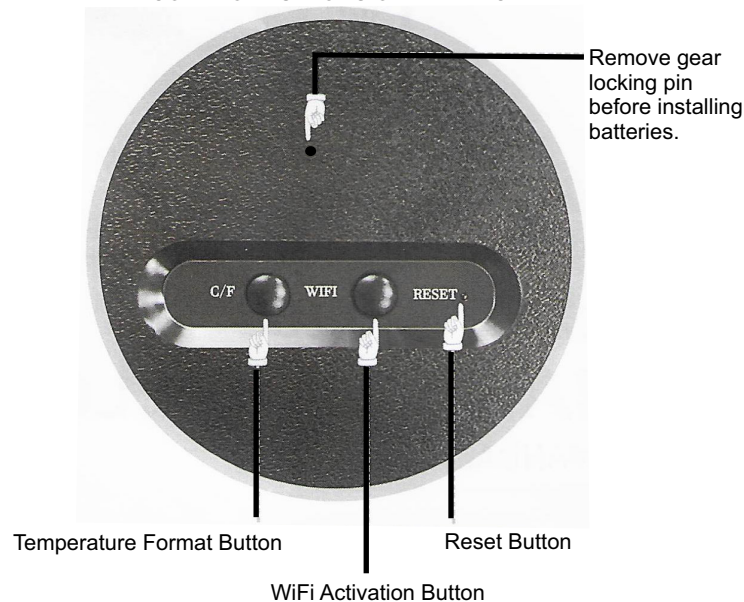

Basic Operation

1. Inserting the batteries or pressing the WiFi button on the back of the clock will enable the WiFi WEB service. The WiFi icon on the LCD display and red LED on the dial will begin flashing, indicating that the clock is searching for the network. When the clock is connected to the network, the icon and LED will remain steady. If the clock does not connect to the network, the icon will blank.
2. When the WiFi WEB service is turned on, pressing the WiFi button will turn the WEB service and red LED off.
3. Press "C/F" to switch between degrees C and degrees F.
4. Inserting batteries will cause the WiFi power to remain on for 10 minutes.
5. Pressing the WiFi button will cause the power to remain on for 5 minutes.
6. A flashing LED indicates the clock is searching for the network.
7. A steady LED indicates the clock is connected to the network.
8. When the LED is off, the WEB service is powered off
9. A fast blinking LED indicates factory settings are being restored.
10. The LED will flash every 10 seconds when the batteries are low.
11. The clocks attempts to obtain time updates randomly between the hours of 19:00 and 22:00 daily.
12. The second hand requires 10 times more battery power than the hour and minute hands. The second hand can be configure to stop between designated hours. To stop the second hand completely, enter 0:00-23:59.
13. The temperature display range is: -9.9C to 50.0C

BRG Precision Products
600 N. River Street
Derby, Kansas 67037
Ph. 316-788-2000
www.brgprecision.com
sales@brgproducts.com



Configuration Menus

Time Menu

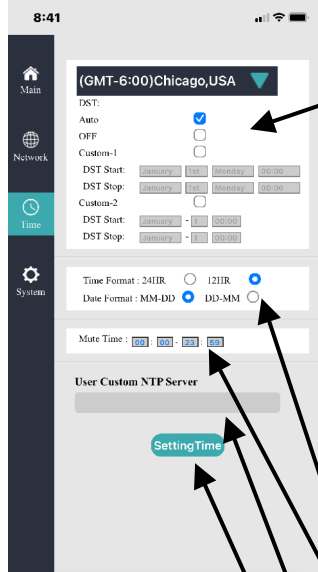

Time Zone: Drop down to select one of 170 cities and time zones.

DST: Default selection is "Auto"

If DST is not required, select "OFF"

If DST rules change, select Custom a mode.

Custom-1: Starts and ends by week.

Example: DST starts at 2:00 on the Last Sunday in March, DST stops at 3:00 on the First Sunday in November, then:

DST Start: March, Last, Sunday, 2:00

DST End: November, 1st, Sunday, 3:00

Custom-2: Starts and ends by date.

Example: DST starts at 2:00, March 25th, and stops at 3:00, October 31st, then;

DST Start: March, 25, 2:00

DST End: October, 31, 3:00

Not available in this model

The second hand requires 10 times more battery power than the hour and minute hands. This setting allows stopping the second hand for all or a fraction of a day.

Enter desired NTP time service IP address.

Example: time.google.com

Press "Setting Time" to save the configuration.

To optionally change the access password, enter the old password and enter a new password. The password requires a minimum of eight (8) characters.

Press the "reset" button to restore the factory default settings.

System Menu

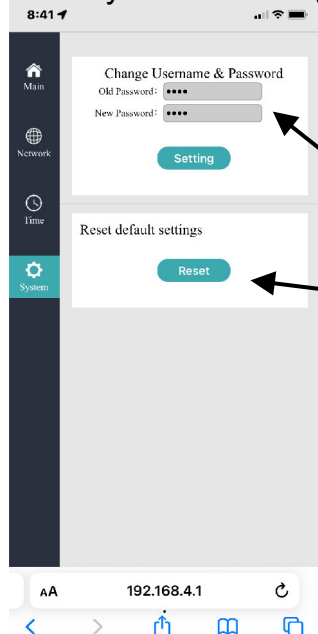

LCD Display Description

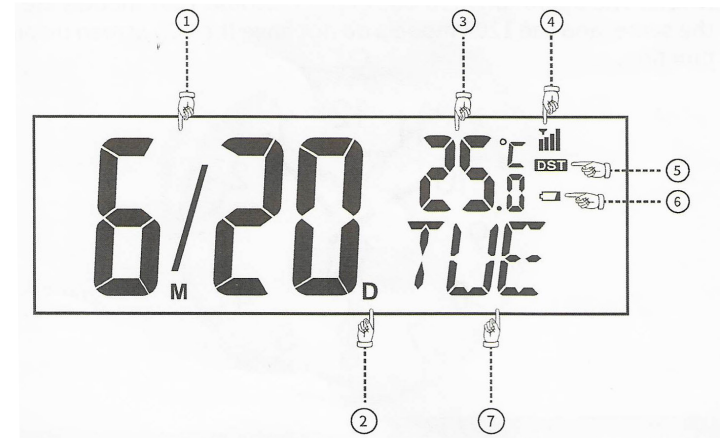

1. Date Display

2. Date Format: Month/Day

3. Temperature: Selectable between F or C

4. Wi-Fi signal strength indicator icon

5. Daylight Saving Time enabled indicator

6. Low battery indicator

7. Day of the Week

Quick Network Setup

Step 1: Remove gear locking pin from the back of the clock.



Next, insert three (3) US Made AA Lithium batteries. Do not use Alkaline or carbon batteries because they only last half as long as Lithium batteries and they are prone to leaking which may damage the clock.

Step 2: Open the WiFi settings menu of your phone or computer.



Step 3: Find the network named "WIFIClock_xxxx", where "xxxx" is the unique clock identifier. Then press the "Connect" button.

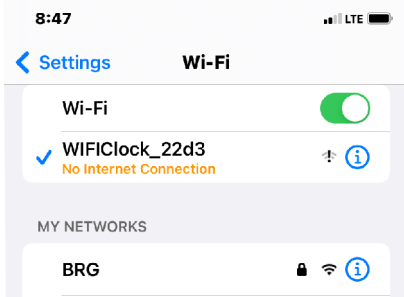

Step 4: Open a network browser and enter in the address bar: "192.168.4.1"

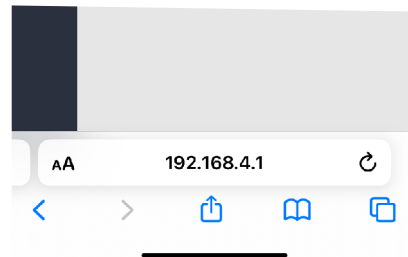

Step 5: Once the clock configuration web page displays, press the "Network" button to enter the network menu.

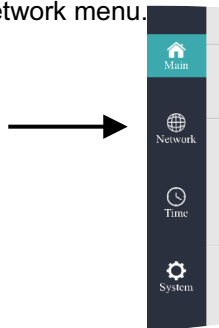

Step 6: Press the "Refresh" button, then pull down the "Router" list and look for the desired router, select it, then press "Connection".

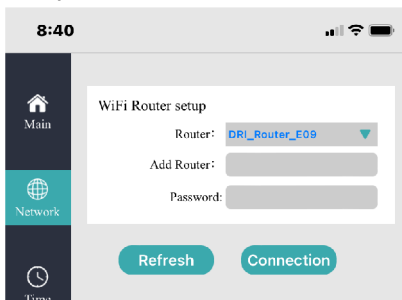

Configuration Menus

Main Menu

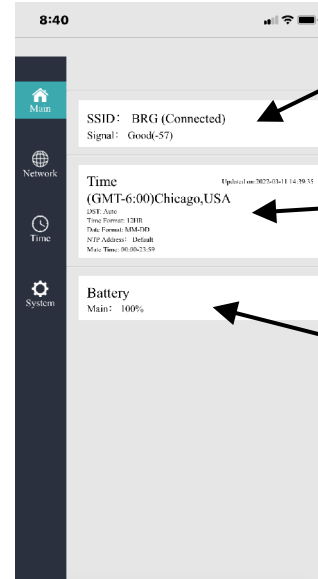

Log into the background homepage automatically, or open the browser manually.

Update details - the time information from the last update is displayed here.

Battery condition - the LED on the clock dial will blink every 10 seconds when the batteries are low.

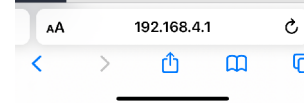

Network Menu

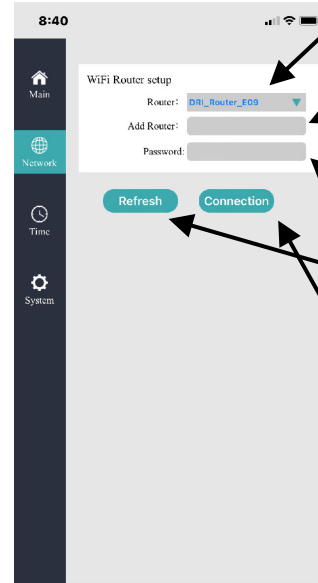

Routers: Pull down to view the available routers.

Add Router: You can manually enter the name of the router here, which will take precedence over the router selection list.

Password: Enter the router password.

Refresh: If the desired router is not listed, press this button to refresh the list.

Connection: After selecting the desired router and entering the password, press this button to connect to the router. There will be a message that the connection is successful after this button is pressed.

